

Don Giovanni

Table of Contents

Rental Information	3
Production Notes	4
Technical Schedule & Notes	5
Line Set Schedule	9
Rail Cue Sheet	12
Mimis	13
Props List	14
Costume Information & Photos	15
Production Photos	29

Contact Information

For rental pricing and availability:

Production Assistant:

Katherine Cattrysse
(612) 342-9582
katherine@mnopera.org

For further renting inquiries:

Production Director:

Kevin Ramach
(612) 342-9583
kramach@mnopera.org

For production technical information:

Technical Director:

Mike McQuiston
(612) 342-9581
mike@mnopera.org

For surtitle rentals and inquiries:

Artistic Administrator:

Roxy Stouffer-Cruz
(612) 342-9571
roxy@mnopera.org

For costume rentals and inquiries:

Costume Shop Manager:

Erica Burds
(612) 342-9576
eburds@mnopera.org

For props rentals and inquiries:

Properties Master:

Dean Hawthorne
(612) 342-9589
dean@mnopera.org

The Minnesota
OPERA
620 North 1st Street
Minneapolis, MN 55401
toll free: (800) 676-6737
fax: (612) 333-0869

Rental Information

Surtitles:	Contact Roxy Stouffer-Cruz at 612-342-9571
Insurance Coverage Required:	\$400,000
Royalties & Production Rights:	
Director (Patrick Mailler)	\$5000
Set Designer (Patrick Mailler)	
Costume Designer (Patrick Mailler)	
Scenery and Wardrobe Supervisors Required: <i>(subject to future increases)</i>	For load-in to rehearsal hall, theater and strike. As a coordinator for fittings.
Fees	\$443.66 per work day \$243.10 per travel day
Housing	Provided by renter
Food Allowance	\$70.00 per day
Transportation	Provided by renter
Approximate Warehouse Costs:	\$3000 each way
Notice for Loading:	2 weeks
Number of Vans:	3 - 53' air ride logistics vans (rail shipment not permitted)

SET TECHNICAL INFORMATION

Minimum Width:		Minimum Depth:	
Total number of line sets:	26	Line sets for Scenery:	2
Line sets for Electrics:	9 + 4 focus tracks	Line sets for Masking:	11
Height of tallest drop:		Can drops be tripped?	n/a
Furthest upstage flying unit:	Black Out Curtain	Weight of heaviest flyer:	150lbs
Largest hard flying unit:		Largest soft flying unit:	16x24
Largest standing unit:		Number of ground cloths:	0

Set designed to include: Raked Deck Deck Turntable Traps Apron Overhead

Hardware available with rental: Assembly Hanging Specialty

Please contact Mike McQuiston, Technical Director, for more information at 612-342-9581 or mike@mnopera.org.

HISTORY OF PREVIOUS USAGE

Company	Year
The Minnesota Opera	2006
Boston Lyric Opera	2009

PLEASE NOTE

If the production is used, all production materials must be returned within thirty days of the final performance. A payment of \$50.00 will be required if said materials are not returned.

Production Notes

CAST

Number of Principals: 5 men - 3 women (7 roles double cast)
Number of Chorus: 14 men – 10 women
Number of Supers 6 men

ARTISTIC STAFF

Conductor	Xian Zhang
Stage Director	Patrick Mailler
Assistant Director	Peter Kozma
Set Designer	Patrick Mailler
Asst. Set Designer	Maria Rosaria Tartaglia
Lighting Designer	Marcus Dilliard
Costume Designer	Patrick Mailler
Chorus Master/Continuo	Bruce Staysna
Wig/Make-up Designer	Chuck Lapointe
Wig/Make-up Designer	Tom Watson
English Surtitles	Floyd Anderson
Surtitled Coordinator	Roxanne Stouffer-Cruz

PRODUCTION STAFF

Costume Director	Gail Bakkom
Technical Director	Mike McQuiston
Production Stage Manager	Alex Farino
Assistant Stage Manager	Angie Spencer
Assistant Stage Manager	Casey Martin
Properties Master	Stanley Dean Hawthorne
Lighting Coordinator	Marc D. Johnson
Charge Painter	Debra Jensen
Production Carpenter	JC Amel
Production Electrician	Bill Healey
Production Fly man	Larry Kline

OWNERSHIP

This production of *Don Giovanni* is owned by The Minnesota Opera. The Scenery, Props and Costumes for this production were built by The Minnesota Opera.

SHOPS

Sets constructed by:	The Minnesota Opera
Costumes constructed by:	The Minnesota Opera Costume Shop
Wigs constructed by:	Tom Watson & Associates

CREW

Load-in Crew: 2 + 14 Carpenters, 2 + 10 Electricians, 1 Props, 4 Transition
Running Crew: 2 + 2 Carpenters (one fly), 2 + 1 Electricians, 2 + 2 Props, 1 Dresser

Date of Load-in: February 26, 2006

MUSIC & ROYALTY

Composer:	Wolfgang Amadeus Mozart
Librettist:	Lorenzo da Ponte
Publisher & Copyright owner:	Bärenreiter
Total number of pit musicians:	39
Breakdown of pit musicians:	6 Violin I, 6 Violin II, 4 Viola, 4 Cello, 2 Bass, 2 Flute, 2 Oboe, 2 Clarinet, 2 Bassoon, 2 Horn, 2 Trumpet, 3 Trombone, 1 Timpani, 1 Mandolin

RUNNING TIMES OF SHOW

ACT I:	82:00
Intermission	20:00
<u>ACT II:</u>	<u>73:00</u>
Total Run Time:	2:57:00

Technical Schedule & Notes

SHOW CREW:

CARP. 2+2 (1 FLY)
 ELEC. 2+1 (BOARD OP, 1DECK, 1 SURTITLE)
 PROPS 2+2
 SOUND 2
 DRESSERS 4 (FEMALE)

PLEASE INCLUDE SHOW CREW ON ALL PRODUCTION CALLS THANK YOU. (DRESSERS AS NOTED.)

WED. 2/22	8AM-5PM CARP. 2+10 TRANS. 3 1PM-10PM ELEC. 2+12	CARP PRE-HANG ELECTRICS PRE HANG
SUN. 2/26	8AM-1PM CARP. 2+14 ELEC 2+2 SOUND 2+2 PROPS 1 TRANS. 4 2PM-11:45PM (MEAL TBD) NOTE: ADD 8 ELEC.@ 2PM	LOAD IN SCENERY LOAD IN
MON. 2/27	8AM- 1PM CARP 2+10 ELEC 2+8 SOUND 2 PROPS 2 2PM- 11:45PM NOTE: ADD 2 PROPS @ 2PM (MEAL TBD)	PRODUCTION & FOCUS CALL PIT- AFTERNOON FOCUS CALL
TUES. 2/28	8AM-5PM CARP 2+3 ELEC 2+6 PROPS 2+2 SOUND 2+2 TRANS. 2 TECH'S 3(LOBBY) MEAL TBD 6PM-11PM SHOW CREW NOTE: CALL DRESSERS AT 6:30PM NOTE: OASIS CALL IN THE AM FOR ½ SHOW & ½ HOUSE CREW	PRODUCTION CALL/ PROPS LOBBY COSTUME LOAD IN PIANO DRESS CAST A 7PM CURTAIN
WED. 3/1	8AM-NOON CARP 2+2 ELEC 2+4 PROPS 2+2 SOUND 2 NOTE: OASIS CALL IN THE AM FOR ½ SHOW & ½ HOUSE CREW 1PM-5PM SHOW CREW NOTE: ONLY 1 DRESSER NEEDED. 6PM- 11PM SHOW CREW	PRODUCTION CALL LIGHTING PIANO DRESS CAST B 1:30PM CURTAIN PIANO DRESS CAST A 7PM CURTAIN

THUR. 3/2	8AM-NOON CARPS 2+2 ELEC 2+4 PROPS 2+2 SOUND 2 1PM-5PM SHOW CREW NOTE: ONLY 1 DRESSER NEEDED. 6PM-11PM SHOW CREW	PRODUCTION CALL PIANO TECH CAST B 1:30PM CURTAIN FINAL ORCHESTRA DRESS CAST A 7:30PM CURTAIN
FRI. 3/3	9:30AM-2:30PM SHOW CREW 3:30PM-? TBD	FINAL ORCHESTRA DRESS CAST B 11AM CURTAIN PRODUCTION CALL
SAT.3/4	PREFORMANCE #1 6PM TBD 7PM SHOW CREW	CONT. 7:30PM CURTAIN SHOW CALL
SUN. 3/5	PERFORMANCE #2 12:30 TBD 1:30PM SHOW CREW	CONT. 2: OOPM CURTAIN SHOW CALL
TUES. 3/7	PERFORMANCE #3 6PM TBD 7PM SHOW CREW	CONT. 7:30PM CURTAIN SHOW CALL
WED. 3/8	PERFORMANCE #4 6PM TBD 7PM SHOW CREW	CONT. 7:30PM CURTAIN SHOW CALL
THUR. 3/9	PERFORMANCE #5 6PM TBD 7PM SHOW CREW	CONT. 7:30PM CURTAIN SHOW CALL
FRI. 3/10	PERFORMANCE # 6 6PM TBD 7PM SHOW CREW	CONT. 7:30PM CURTAIN SHOW CALL
SAT. 3/11	PERFORMANCE # 7 6PM TBD 7PM SHOW CREW	CONT. 7:30PM CURTAIN SHOW CALL
SUN. 3/12	PERFORMANCE # 8 12:30	CONT.

TBD
1:30PM
SHOW CREW

2:OOPM CURTAIN
SHOW CALL

6:30PM-11:30PM
CARP. 2+16
ELEC 2+10
PROPS 2+2
SOUND 2+2
LOBBY 3
TRANS 4

LOAD OUT

MON. 11/15

8AM-5PM
CARP 2+10
ELEC 2+10
PROPS 2
SOUND 2
TRANS 2

RESTORE

ONSTAGE TECH REQUIREMENTS:

Headsets

- 1 Headset at tech table for Marcus (LD) to Channel A
- 1 Headset at tech table for Marc (ALD) to Channel A
- SM headset console on wood table behind the tech table
- 2 wireless headsets for ASM's: Angie SR and Casey SL
- 3 wireless headsets for Production Carpenter, Deck Carpenter, Deck Electrician
- Headset set-up in super-title booth
- Headset for Light Board Operator
- Handset at pit door
- Usual rail speakers

Audio and Video Monitors

- Conductor monitor and full stage monitor at SM desk
- At the stage manager console could Monitor 1 be full stage color, Monitor 2 conductor and the monitor on top of the console full stage infrared.
- Conductor monitors in Queens Boxes
- Conductor Monitors in Ordway Proscenium
- Roving carts DSR and DSL with conductor and audio monitor
- Roving carts USR and USL with conductor monitor
- Standard Opera audio monitor set-up
- Show feed to all dressing rooms, hallways, and rehearsal halls
- Paging System to all dressing rooms, rehearsal halls and hallways

Microphones

- Microphones at piano and forte piano in the pit starting on Tuesday at 7:00 pm.
- Director God microphone in house for all lighting sessions and onstage rehearsals beginning at 1pm on Tuesday
- From Tuesday through Wednesday evening, I will need to have a dressing room page mike & SM god mic at my station in house.
- Dressing room page microphone and house announce microphone at SM console beginning Thursday evening.
- We will be having singing from the pit. The COMMENDATORE has several extended moments in the pit and the chorus men sing for about 2:00 at the end of the opera. These might need microphones reinforcement.

Cue Lights

- Conductor cue light
- 2 set of cue lights on the rail
- 1 cue light to sound board
- 1 set of cue lights to rain operator
- 1 set of cue lights for sunrise/sunset traveler operator
- Crew warning light for in crew hall

-SM cue light controls to be at the tech table Tuesday thru Thursday afternoon

Music stands, lights, chairs and podiums (*all the music stand lights gelled)

-For SR ASM -1 lit music stand* USR

-For SL ASM -1 lit music stand* USL

-2 lit music stands* in house near production table

-1 lit music stands* in house behind conductor with 2 chairs

-2 lit music stands* house left, orchestra section, last row on aisle for members of music staff

In pit

-1 Piano with light-piano forte on platform for Tuesday evening

Tech tables

-Standard Tech tables at back of orchestra sections

-2 small wood tables behind the tech table for SM

-goose neck lights for Lighting Designer, Assistant Lighting Designer, Director and Assistant Director

-power strips at for all tech tables

Props

-2 black prop shelves: 1 USR and 1 USL

-1 8' table SR (if necessary)

-1 small wood table in Opera Production Office

-1 six foot table in front of mirror outside the basement dressing rooms

-chrome wire shelf unit for wigs outside the basement dressing rooms

-Wig Dryer outside Wig and Make-Up Room.

-Costume rolling cart in hallway near production office for Opera staff coats

-The Drake Room will be used for chorus warm-up. We will need the piano in the room.

-The US Bank Room will be used for intermission receptions



Line Set Schedule

LINE SET	PLASTER LINE	BATTEN LENGTH	OMT HOUSE PLOT	PRODUCTION HANGING PLOT	SCENE	CO.	SIZE (WxHxD)	WT	TRIM (LO/HI)	NOTES
NA		NA		Surtile Screen	ALL	MOC	3'-0"x24'-0"	40	28'6"	HUNG FROM #1 CATWALK
PL	0'-0"		Plaster Line							
FC	1'-0"		Fire Curtain							
1	1'-8"	86'	House Teaser	PORTAL BORDER		OCPA	84X12		28'	HANG CENTER
2	2'-4"	86'	House Curtain	BOC		OCPA	72X38		27'	HANG CENTER NO 5/8 FULL)
3	3'-0"	86'	No. 1 Portal Border	RAIN GAG		MOC	80'		30'	TBD
4	3'-6"	86'	No. 1 Portal Legs							
WELL										
5	4'-6"	86'	No. 1 Lighting Truss	#1 ELECTRIC					34'-6"	
6	5'-0"	62'	Trapped By Truss							
7	5'-6"	62'	General Purpose Set							
8	6'0"	62'	General Purpose Set	#1 BORDER		OCPA	84X12		27'	HANG CENTER
9	0	62'	General Purpose Set							
10	7'-0"	62'	Restricted Use Set	#1 FOCUS TRACK		MOC	60'			HANG CENTER
11	7'-6"	62'	Orchestra Ceiling							
12	8'-0"	62'	Restricted Use Set							
13	8'-6"	62'	General Purpose Set	#2 ELECTRIC					31'-6"	
14	9'-0"	62'	General Purpose Set							
15	9'-6"	86'	General Purpose Set							
16	10'-0"	86'	No. 1 Black Border							
17	10'-6"	86'	No. 1 Black Legs							
18	11'-0"	62'	General Purpose Set	#2 BORDER		OCPA	84X12		27'	HANG CENTER
19	11'-6"	62'	General Purpose Set							
WELL										
20	12'-6"	62'	General Purpose Set	#3 ELECTRIC					30'-6"	
21	13'-0"	62'	General Purpose Set							
22	13'-6"	62'	General Purpose							

			Set							
23	14'-0"	62'	General Purpose Set	#2 FOCUS TRACK		MOC	60'			HANG CENTER
24	14'-6"	62'	General Purpose Set							
25	15'-0"	62'	General Purpose Set							
26	15'-6"	62'	General Purpose Set	#4 ELECTRIC					33'	
27	16'-0"	62'	General Purpose Set							
28	16'-6"	62'	General Purpose Set	WINDOW		MOC	6'8X14'		TO DECK	
29	17'-0"	86'	No. 2 Black Border							
30	17'-6"	86'	No. 2 Black Legs	#3 BORDER		OCPA	84X12		27'	HANG CENTER
31	18'-0"	86'	General Purpose Set							
32	18'-6"	62'	General Purpose Set							
33	19'-0"	62'	General Purpose Set	#5 ELECTRIC					31'	
34	19'-6"	62'	General Purpose Set							
WELL										
35	20'-6"	62'	General Purpose Set							
36	21'-0"	62'	General Purpose Set	#3 FOCUS TRACK		MOC	60'			HANG CENTER
37	21'-6"	62'	General Purpose Set							
38	22'-0"	62'	General Purpose Set							
39	22'-6"	62'	General Purpose Set							
40	23'-0"	62'	General Purpose Set	#6 ELECTRIC					34'	
41	23'-6"	62'	General Purpose Set							
42	24'-0"	86'	No. 3 Black Border							
43	24'-6"	86'	No. 3 Black Legs							
44	25'-0"	86'	General Purpose Set	SOUND X-OVER					TBD	
45	25'-6"	62'	General Purpose Set							
46	26'-0"	62'	General Purpose Set							

47	26'-6"	62'	General Purpose Set							
48	27'-0"	62'	General Purpose Set							
49	27'-6"	62'	General Purpose Set	#4 BORDER		OCPA	84X12		27'	HANG CENTER
WELL										
50	28'-6"	62'	General Purpose Set							
51	29'-0"	62'	General Purpose Set							
52	29'-6"	62'	General Purpose Set							
53	30'-0"	62'	General Purpose Set							
54	30'-6"	62'	General Purpose Set							
55	31'-0"	86'	No. 4 Black Border	DROP						
56	31'-6"	86'	No. 4 Black Legs							
57	32'-0"	86'	General Purpose Set							
58	32'-6"	62'	General Purpose Set							
59	33'-6"	86'	No. 2 Lighting Truss	#7 ELECTRIC					34'-6"	
60	34'-6"	62'	General Purpose Set	#4 FOCUS TRACK		MOC	60'			HANG CENTER
61	35'-0"	62'	General Purpose Set							
62	35'-6"	62'	General Purpose Set	#8 ELECTRIC					36'	
WELL										
63	36'-6"	86'	General Purpose Set							
64	37'-0"	86'	General Purpose Set	#5 BORDER		MOC	84X12		TBD	HANG CENTER(CMA)
65	37'-6"	86'	General Purpose Set	LEGS		OCPA	20X38			START 28' LEFT AND RIGHT OF CENTER
66	38'-0"	86'	General Purpose Set	BOC		OCPA	60X34			HANG CENTER
67	38'-6"	86'	General Purpose Set	BLACK SCRIM		OCPA	60X34			HANG CENTER
68	39'-0"	86'	General Purpose Set	PLASTIC		OCPA	60X38			HANG CENTER
69	39'-6"	86'	General Purpose Set							
70	40'-0"	86'	General Purpose Set	#9 ELECTRIC (US Truss)					34'-0"	

Rail Cue Sheet

PRE-SHOW MOVES

#3 Rain Rig IN low for priming and then OUT to IN

PRESET

#1	Portal Border	IN
#2	Blackout Curtain	IN
#3	Rain Rig	IN to IN
#8	#1 Border	IN
#15	Window	OUT
#18	#2 Border	IN
#30	#3 Border	IN
#49	#4 Border	IN
#55	Drop	OUT
#64	#5 Border	IN
#65	Legs	IN
#66	Blackout Curtain	OUT
#67	Black Scrim	OUT
#68	Plastic phone	IN OFF

ACT 1 (85:00)

<u>Cue #</u>	<u>Lineset</u>	<u>Item</u>	<u>IN/OUT</u>	<u>Speed</u>	<u>Light</u>	<u>Placement</u>	<u>Time</u>
RQ 1	#2	Blackout Curtain	OUT	7 count	red	10/1/1	6:30
RQ 1a	#3	Rain Rig sneak	OUT	7 count	verbal	13/ w/ clear	11:30
RQ 1b	#3	Rain Rig sneak	IN	7 count	verbal	67/1/1	33:30
RQ 1c	#3	Rain Rig sneak	OUT	7 count	verbal	73/ w/ clear	37:30
RQ 1d	#67	Black Scrim	IN	10count	red	129/5/1	62:30
RQ 2	#2	Blackout Curtain	IN	7 count	red	212/2/2	85:00

INTERMISSION MOVES (20:00)

#3 Rain Rig IN to low for bleeding and drying and then OUT to OUT

ACT 2 (74:00)

<u>Cue #</u>	<u>Lineset</u>	<u>Item</u>	<u>IN/OUT</u>	<u>Speed</u>	<u>Light</u>	<u>Placement</u>	<u>Time</u>
RQ 3	#2	Blackout Curtain	OUT	7 count	red	213/before music	-00:00
RQ 4	#15	Window	IN	10 count	red	222/1/1	3:30
RQ 5	#15	Window	OUT	10 count	red	253/3/2	22:00
RQ 6	#55	Drop	IN	12 count	red	296/3/2	36:30
RQ 7	#55	Drop	OUT	5 count	red	312/3/1	44:30
RQ 8	#66	US Blackout	IN	10 count	red	321/1/1	53:00
RQ 9	#66	US Blackout	OUT	7 count	red	357/1/1	72:30
RQ 10	#2	Blackout Curtain	IN	7 count	red	377/cut-off	74:00
RQ 11	#2	Blackout Curtain	OUT	7 count	red		for bows
RQ 12	#2	Blackout Curtain	IN	7 count	red		after bows

Minis

Basic

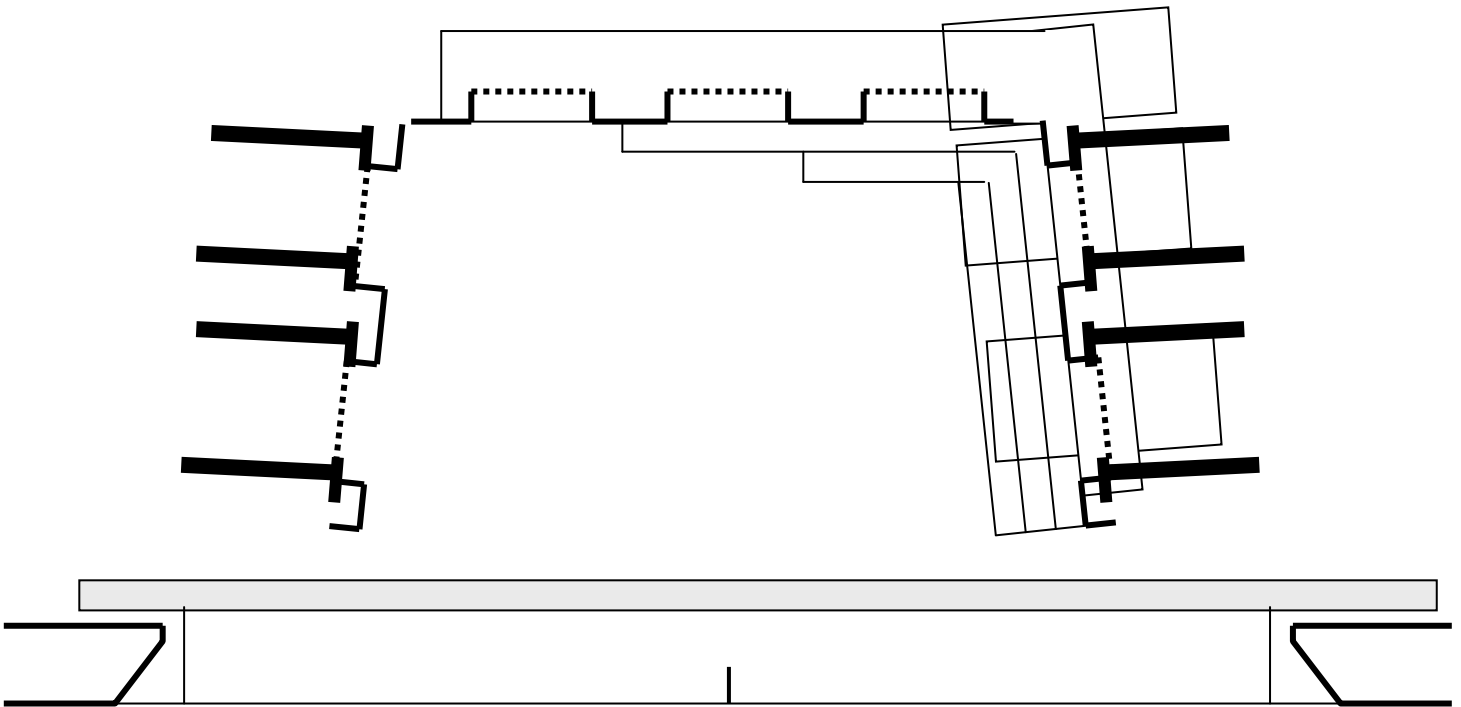

Props List

Qty	Prop	Notes
1	Motorbike	
1	Set of side bags for motorbike	
2	Wrenches	Live in saddlebag
1	White rag	Lives in saddlebag
1	Perfume bottle	Lives in saddlebag
1	Book (2-3 spare)	Lives in saddlebag, page ripped from it nightly
1	Umbrella (1 spare)	
6	Traveling suitcases	
1	Small makeup suitcase	
1	Pocket watch	For LEPORELLO
1	Sword in belt	For COMMENDATORE
1	Wedding flower bouquet	For ZERLINA
1	Old tripod camera	Carried on by SUPER
1	Small pistol	For DON OTTAVIO
1	Large pistol	For MASETTO
1	Hunting gun	For MASETTO, no shoulder strap needed
1	Heart shaped balloon train	SUPER brings on
?	Small children's bubble makers	For CHORUS women and select men
1	Old phonograph	
4	3'4 x 6'7 Tables	
4	Red tablecloths	Sewn together
4	White tablecloths	
20	Plates	
2	Sauce bowls	
24	Champagne glasses	
4	Fruit tall crystal platters	
4	Silver trays with lids	
1	Small silver tray without lid	With doily attached
2	Large silver trays	With non slip surface for champagne glasses
4	champagne buckets with champagne bottles	
4	Candelabras	With 16 lit candles total
2	Water pitchers	1 crystal, one silver
13	Wooden chairs	
6	Old battery lamps	For male CHORUS, all practical
1	Large red oriental rug	For on top of 4 tables when together
1	Wallet	For D. GIOVANNI, with money inside
2	Handkerchiefs	1 male for GIOVANNI, 1 female for ELVIRA
1	apple	Red, edible
2	round loafs of bread	For on tall fruit trays
1	White napkin	
1	Set of silverware	Knife and fork only
1	Rectangle silver tray	
	Fried chicken and vegetables	Edible, replaced nightly
	Grape juice/cranberry juice	

Costume Information & Photos

Italicized items are not provided. Men's Formal Wear is available for an additional rental fee.

Don Giovanni
Act One
<i>White t-shirt</i>
White collarless shirt
Starched white shirt front
White wing tip collar
<i>Collar studs, cufflinks, shirt studs</i>
Black dress pants
White formal vest
White silk bowtie
Black tailcoat w/white pocket hankie
Black cape w/red satin lining
Collapsible top hat
White leather dress gloves
<i>Monocle</i>
<i>Black socks</i>
Off-white silk spats
<i>Black patent shoes</i>

Don Giovanni
Act Two
REMOVE ONSTAGE:
Top hat
Cape
ADD ONSTAGE:
Brown leather trench coat
Brown leather helmet w/goggles

Don Giovanni
Act Two
REMOVE ONSTAGE:
Coat
Helmet
ADD ONSTAGE:
Red velvet smoking jacket w/black satin belt, cuffs and lapels



Leporello
Act One
<i>White t-shirt</i>
White sleeveless shirt
White coach plastron
Black formal trousers
Greenish-yellow and black striped vest w/black sleeves
<i>Silver pocket watch</i>
White gloves
<i>Eyeglasses</i>
Brown leather trench coat
Brown leather helmet w/goggles
<i>Black socks</i>
Off-white spats
<i>Black shoes</i>

Leporello
Act Two
REMOVE ONSTAGE:
Trench coat
Helmet w/goggles
ADD ONSTAGE:
Collapsible black top hat
Black cape w/red satin lining

Leporello
Act Two
REMOVE ONSTAGE:
Top hat
Cape



Zerlina**Act One**

Off-white silk satin dress w/pink
ombréd ruffles

Lace capelet w/pearl details

Wedding ring

White fan-shaped hair comb

Pale pink tights

Pale pink shoes

Donna Elvira**Acts One & Two**

White linen underdress

Pregnancy pad

Aqua-green striped jacket

Hankie

Wedding ring

Red gloves

Eyeglasses

White tights

Tan and cream boots

Aqua-blue straw hat w/red trim

Donna Elvira**Acts One & Two**

REMOVE:

Jacket

Hat

ADD:

White ruffle collar

Aqua-green sleeveless vest

Black striped coat

Black short-hat w/mask



Donna Anna
Acts One & Two
<i>Foundation garments</i>
Grey to black ombréd pants-dress
<i>Cross necklace</i>
Grey to black ombréd shawl w/black fringe
<i>Black tights</i>
<i>Black shoes</i>

Donna Anna
Acts One & Two
REMOVE:
Dress
<i>Necklace</i>
Shawl
ADD:
Purple to pink ombréd dress w/black lace overlay
Deep purple belt
<i>Black jet necklace</i>

Donna Anna
Acts One & Two
<i>Same foundation garments</i>
White dickie
Purple vest and jodhpurs
Black striped coat
Red gloves
<i>Same tights</i>
<i>Black boots</i>
Black hat w/mask



Don Ottavio
Acts One & Two
Cream long johns
Red brocade robe
<i>Dark brown cordovan slippers</i>
Hair net

Don Ottavio
Acts One & Two
<i>White t-shirt</i>
White shirt
Grey and black striped trousers
Yellow plaid vest
Royal blue jacket w/black velvet lapels
Red print necktie
<i>Black socks</i>
Cream spats
<i>Black shoes</i>
Black bowler hat

Don Ottavio
Acts One & Two
REMOVE:
Jacket
Hat
ADD:
Black striped coat
Grey gloves
Black bowler w/mask



Masetto
Act One
<i>White t-shirt</i>
Blue and white striped shirt w/white collar and cuffs
Cream linen pants
Apricot vest
Red paisley necktie
Cream linen jacket
<i>Apricot socks</i>
<i>Brown shoes</i>
Straw boater

Commendatore
Act One
<i>White t-shirt</i>
White shirt
Cream wool trousers
Cream wool tailcoat w/military trim
<i>Gold and black sword belt</i>
White gloves
<i>Black socks</i>
<i>Black patent shoes</i>

All Male Supers
Acts One & Two
<i>White t-shirt</i>
White sleeveless shirt
White coach plastron
Black formal trousers
Black and grey striped vest w/sleeves
White gloves
Grey spats
<i>Black socks</i>
<i>Black shoes</i>



Female Chorus #1**Acts One & Two**

Dress shields

Pale olive striped dress w/border overlay and sheer cream embroidered beaded bodice

Black velvet belt

Dark cream knit gloves

*Cream tights**Brown and cream shoes*

Olive fan-shaped hair comb

ADD:

Red gloves

Female Chorus #2**Acts One & Two**

Dress shields

Dark red underdress w/black ribbon trim

Pink overdress w/black striped collar and border

Black satin belt

Off white lace gloves

*Black tights**Black shoes*

Off white hair comb

ADD:

Red gloves

Female Chorus #3**Acts One & Two**

Dress shields

Dark red underskirt

Cream and coral striped overdress w/appliqué flowers

Black velvet belt

Cream knit gloves

*Cream tights**Dark red shoes*

Fan-shaped hair comb

ADD:

Red gloves



Female Chorus #4**Acts One & Two**

Dress shields
Cream and peach underdress
Peach striped overdress w/red flower appliqués
Dark red velvet belt
Dark cream scrunched gloves
<i>Light cream tights</i>
<i>Cream lace up boots</i>
Straw hat
ADD:
Red gloves

Female Chorus #5**Acts One & Two**

Dress shields
Grey underdress
Dark grey overdress with yellow border
Yellow belt
Golden yellow gloves
<i>Cream tights</i>
<i>Brown and cream shoes</i>
Straw hat with black trim
ADD:
Red gloves

Female Chorus #6**Acts One & Two**

Dress shields
Pale green underdress w/green sleeves
Pale green overdress w/satin floral trim
Green striped belt
Pale coral gloves
<i>Dark cream tights</i>
<i>Brown and cream shoes</i>
Gold fan-shaped hair comb
ADD:
Red gloves



Female Chorus #7**Acts One & Two**

Dress shields
Black underdress
Black overdress
Black lace snap-in collar
Black velvet belt
Black lace gloves
<i>Black tights</i>
<i>Black tie shoes</i>
Black straw hat w/black and gray striped trim

Female Chorus #8**Acts One & Two**

Dress shields
Blue underdress
Light tan overdress w/black bias striped border
Black velvet belt
Very pale grey gloves
<i>Black tights</i>
<i>Dark red shoes</i>
Black hair comb
ADD:
Red gloves

Female Chorus #9**Acts One & Two**

Dress shields
Aqua-blue underdress
Sheer cream and coral striped overdress
Black velvet belt
Cream net gloves
<i>Light cream tights</i>
<i>Brown and white shoes</i>
Straw hat
ADD:
Red gloves



Female Chorus #10**Acts One & Two**

Dress shields
 Dark red underdress
 Light peach overdress w/gold print border
 Dark red velvet belt
 Cream cotton gloves w/seed pearls
Cream tights
Dark red shoes
 Rust fan-shaped hair comb
 ADD:
 Red gloves

Male Chorus #1**Acts One & Two**

White t-shirt
 White dress shirt
 Brown tweedy pants and jacket
 Cream and brown striped necktie
Patterned socks
Brown shoes
 Straw boater w/black trim

Male Chorus #2**Acts One & Two**

White t-shirt
 White dress shirt
 Tan plaid knee breeches
 Tan plaid vest
 Brown print bowtie
 Tan plaid jacket
 Brown argyle knee socks
Brown shoes
 Tan cap



Male Chorus #3**Acts One & Two***White t-shirt*

White dress shirt

Dark olive green pants

Red and gold plaid vest

Maroon, cream and red striped necktie

Dark olive green jacket w/gold binding

*Brown socks**Brown shoes*

Cream straw hat

Male Chorus #4**Acts One & Two***White t-shirt*

White dress shirt

Medium-brown pants

Blue-grey plaid vest

Gold and brown print bowtie

Blue-grey plaid jacket

*Dark brown argyle socks**Dark brown shoes*

Straw boater w/black trim

Male Chorus #5**Acts One & Two***White t-shirt*

White dress shirt

Dark brown pants

Golden tan jacket

Rust, brown and cream striped necktie

*Brown socks**Dark brown shoes*

Straw boater w/black trim



Male Chorus #6**Acts One & Two***White t-shirt*

White shirt

Brown herringbone pants

Gold knit necktie

Brown herringbone vest

Brown herringbone jacket

*Brown socks**Dark brown shoes*

Straw hat w/telescope crown

Male Chorus #7**Acts One & Two***White t-shirt*

White dress shirt

Tan pants

Blue jacket

Red, blue and grey striped necktie

*Taupe socks**Brown shoes*

Straw boater w/ black trim

Male Chorus #8**Acts One & Two***White t-shirt*

White dress shirt

Dark brown pinstriped pants and jacket

Brown necktie w/cream polka dots

*Dark brown socks**Brown shoes*

Straw boater w/black trim



Male Chorus #9**Acts One & Two***White t-shirt*

White dress shirt

Tan plaid pants and jacket

Green plaid necktie

*Beige socks**Brown shoes*

Straw hat w/brown trim

Male Chorus #10**Acts One & Two***White t-shirt*

White dress shirt

Pale grayish-beige plaid pants

Pale grayish-beige jacket w/brown
corduroy trim

Dark red and gold patterned necktie

*Beige socks**Dark brown shoes*

Straw hat w/telescope crown

Male Chorus #11**Acts One & Two***White t-shirt*

White dress shirt

Greyish-brown pants and double-
breasted jacket

Dark red and grey plaid necktie

*Brown socks**Dark brown shoes*

Straw panama hat w/brown trim



Male Chorus #12
Acts One & Two
<i>White t-shirt</i>
White dress shirt
Light brown pinstriped pants, vest and jacket
Brown and grey striped necktie
<i>Light brown socks</i>
<i>Dark brown tie shoes</i>
Straw boater w/black trim

Male Chorus #13
Acts One & Two
<i>White t-shirt</i>
White dress shirt
Dark brown pinstriped pants and double-breasted jacket
Red silk checkered necktie
<i>Brown socks</i>
<i>Dark brown tie shoes</i>
Straw boater w/black trim



Production Photos



but then, Masetto,
let's make peace.



